

# BOX23 Specification



## Overview

Decenta BOX23 is widely used in edge computing application scenarios, which can meet the needs of security, community, superstore and other complex environments.

- Built-in Rexchip RK3588 processor platform.
- Peripheral interfaces and expandable Wi-Fi/5G communication mode.
- Support -20 °C~60 °C working temperature.
- Small size and strong environmental adaptability.
- Rich interface, including HDMI® Out, DP, USB, Type-C, COM, Audio, etc.
- Passive cooling, support cloud edge collaboration, easy maintenance.
- Supports Wi-Fi 6+BT5.0, optional 5G.



## I/O Overview

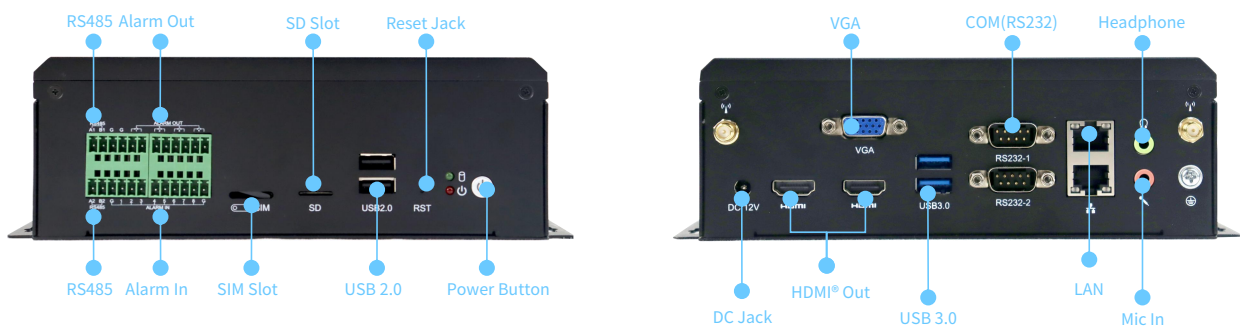

# Specifications

Model		S22-RK3588-BOX23	
CPU		Rockchip RK3588 Quad Cores A76+Quad Cores A55,max 2.6GHz	
Memory	Type	Onborad,32bit LPDDR4x-8GB	
	Capacity	Max.16GB	
Network	5G	M.2	
	Wi-Fi	AP6275P,support WIFI 6+BT5 *	
Storage	eMMC	Onborad,eMMC5.1 Max.64GB	
I/O	Front	USB 2.0	2
		COM	2x RS485
		ALARM OUT	4
		ALARM IN	8
		SIM Slot	1,support nano SIM slot
		SD Slot	1
		LED	2(Power_LED/ HDD_LED)
		Power Button	1
		Reset Hole	1
	Rear	LAN	2
		USB 3.0	2
		HDMI® Out	2
		VGA	1,optional
		Headphone	1
		Mic In	1
		COM	2x RS232
		Antenna	2
		DC Jack	1
	Environment	Temperature	Operating
Storage			-20°C-60°C
Humidity		Operating	10%~90% non-condensing
		Storage	5%~95% non-condensing
Power		DC 12V	
OS		Debian11	
Dimensions		204mm x 174mm x 65.5mm	
Remark		* WIFI module and 5G module can not work at the time	

## Dimensions (Unit: mm)

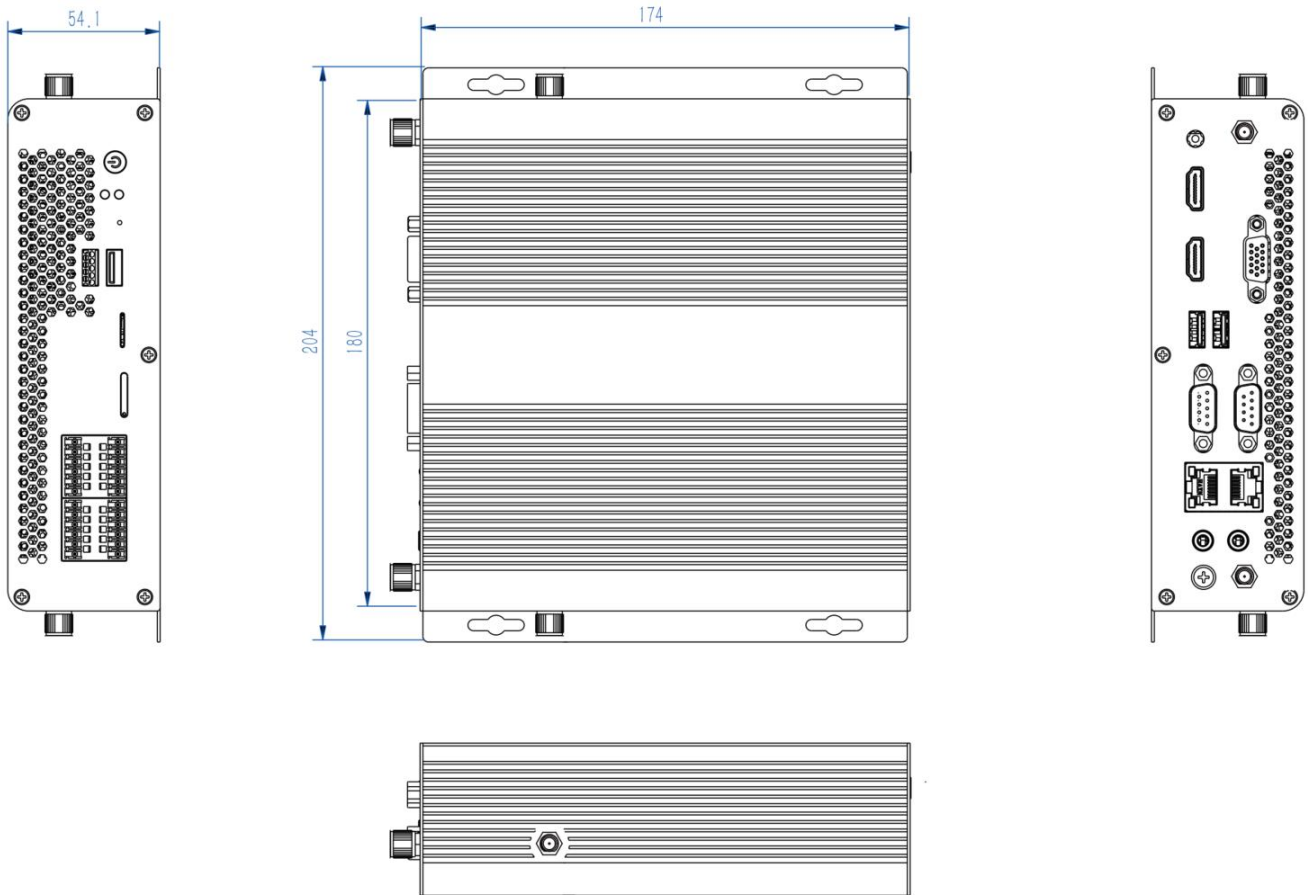

\*Specifications and information contained in this document are furnished for informational use only, and are subject to change at any time without notice, and should not be construed as a commitment by Decenta.